

P:\CPA Scheide Houses - Kitchen 013-202 CPA Scheide Houses 2.dwg, 7/6/2020, 4:56:52 PM, © Struxures 2017

Material Symbols	
	EARTH
	AGGREGATE BASE
	SAND/GYPSUM BOARD
	CONCRETE
	BRICK
	CONCRETE MASONRY UNIT
	IVANY BLOCK
	METALS
	FINISHED WOOD
	ROUGH WOOD
	PLYWOOD
	RIGID INSULATION
	GLASS FIBER INSULATION
	NEW STUD CONSTRUCTION
	EXISTING CONSTRUCTION TO REMAIN
	EXISTING CONSTRUCTION TO BE REMOVED

Drawing Symbols	
	WALL SECTION MARKER SECTION IDENTIFICATION DRAWING NUMBER
	BUILDING SECTION MARKER SECTION IDENTIFICATION DRAWING NUMBER
	DETAIL MARKER DETAIL IDENTIFICATION DRAWING NUMBER
	INTERIOR ELEVATION MARKER ELEVATION DRAWING IDENTIFICATION ELEVATION IDENTIFICATION
	ROOM IDENTIFICATION ROOM NAME ROOM NUMBER ANY ADD. INFO.
	DOOR IDENTIFICATION ROOM NUMBER DOOR NUMBER
	PLAN NOTE PLAN NOTE NUMBER
	WINDOW IDENTIFICATION WINDOW MARK
	REVISION REVISION NUMBER
	WALL TYPE WALL TYPE NUMBER
	DEMOLITION NOTE DEMOLITION NOTE NUMBER

Abbreviations			
A.C.T.	ACOUSTICAL CEILING TILE	HORIZ	HORIZONTAL
AFF	ABOVE FINISHED FLOOR	HWR	HOT WATER RETURN
ALUM	ALUMINUM	HWS	HOT WATER SUPPLY
APT	APARTMENT	INSUL	INSULATION
B&B	BALLED AND BERLAP	J	JAMB
BD	BOARD	L.P.	LAMINATED PLASTIC
BLDG	BUILDING	LAM	LAMINATE
BLKG	BLOCKING	MAS.	MASONRY
CB	CATCH BASIN	MECH	MECHANICAL
CJ	CONTROL JOINT	MAX	MAXIMUM
CL	CENTERLINE	MIN	MINIMUM
CLR	CLEAR	M.H.	MANHOLE
CLG	CEILING	MTL	METAL
CMG	CERAMIC MOSAIC TILE	MK	MARK
CMU	CONCRETE MASONRY UNIT	MRGWB	MOISTURE RESISTANT GYPSUM WALL BOARD
CONC	CONCRETE	N	NORTH
OPT	CARPET	NIC	NOT IN CONTRACT
OT	CERAMIC TILE	NTS	NOT TO SCALE
DN	DOWN	O.C.	ON CENTER
DS	DOWN SPOUT	P.C.	PLUMBING CONTRACTOR
DWG	DRAWING	PLAS	PLASTIC
EXIST	EXISTING	PL or P.LAM	PLASTIC LAMINATE
ELEC	ELECTRIC	PLUMB.	PLUMBING
E.C.	ELECTRICAL CONTRACTOR	PP	PEAT POT
E.I.F.S.	EXTERIOR INSULATION FINISH SYSTEM	PT	PAINT/PRESSURE TREATED
E.J.	EXPANSION JOINT	P.V.C.	POLYVINYL CHLORIDE
ELEV	ELEVATION	QT	QUARRY TILE
EQ	EQUAL	QUA.	QUANTITY
EXT	EXTERIOR	RC	ROOT CUTTING
FD	FLOOR DRAIN	RD	ROOF DRAIN
FIN	FINISH	REQD	REQUIRED
FLR	FLOOR	SIM	SIMILAR
FLUOR	FLUORESCENT	TB	TOWEL BAR
FE	FIRE EXTINGUISHER	TTD	TOILET TISSUE DISPENSER
FT	FOOT/FEET	TYP	TYPICAL
G	GAS LINE	V	VINYL
GAL	GALLON	VCT	VINYL COMPOSITION TILE
GWB	GYPSUM WALL BOARD	VERT	VERTICAL
GYP	GYPSUM	VWC	VINYL WALL COVERING
H	HEAD	w/	WITH
H.C.	HEATING CONTRACTOR	WD	WOOD
HM	HOLLOW METAL	WWF	WELDED WIRE FABRIC

Drawing Index	
Drawing Number	Description
CS	Cover Sheet
A1	Kitchen Plan and Elevations

Project Data	
Code Information	Existing Building Code 2015 V B S TITUSVILLE HISTORIC DISTRICT - NATIONAL REGISTER OF HISTORIC PLACES

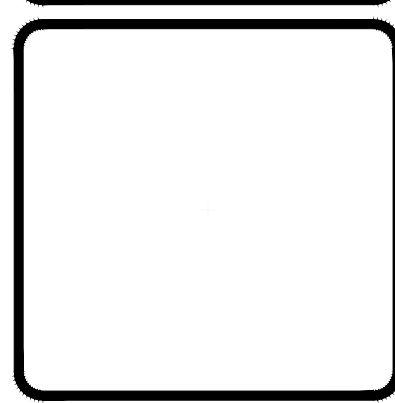
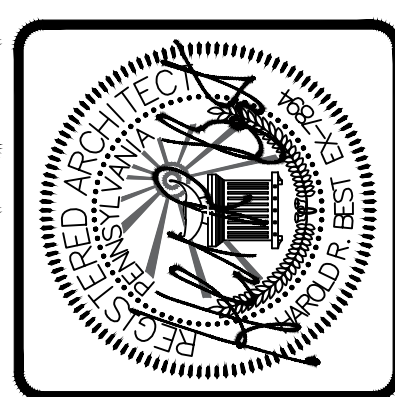

STRUXURES
ARCHITECTURE / CONSTRUCTION
9545 State Route 257
Seneca, PA 16346
Phone: (814) 676-1432
Phone / Fax: (814) 676-1532

William H. Scheide House

(hereinafter referred to as the Scheide House)

Kitchen Rehabilitation

221 North Washington Street, Titusville, PA 16354



Site Location Map
SCALE: N.T.S.

Revisions

Kitchen Rehabilitation Scheide House 221 North Washington Street, Titusville, PA 16354 Drawing Name Cover Sheet

Scale:	As Noted
Job Number:	013-20
Date:	02.06.2019
Drawn:	DMG
Check:	HRB
Drawing Number:	CS

CS

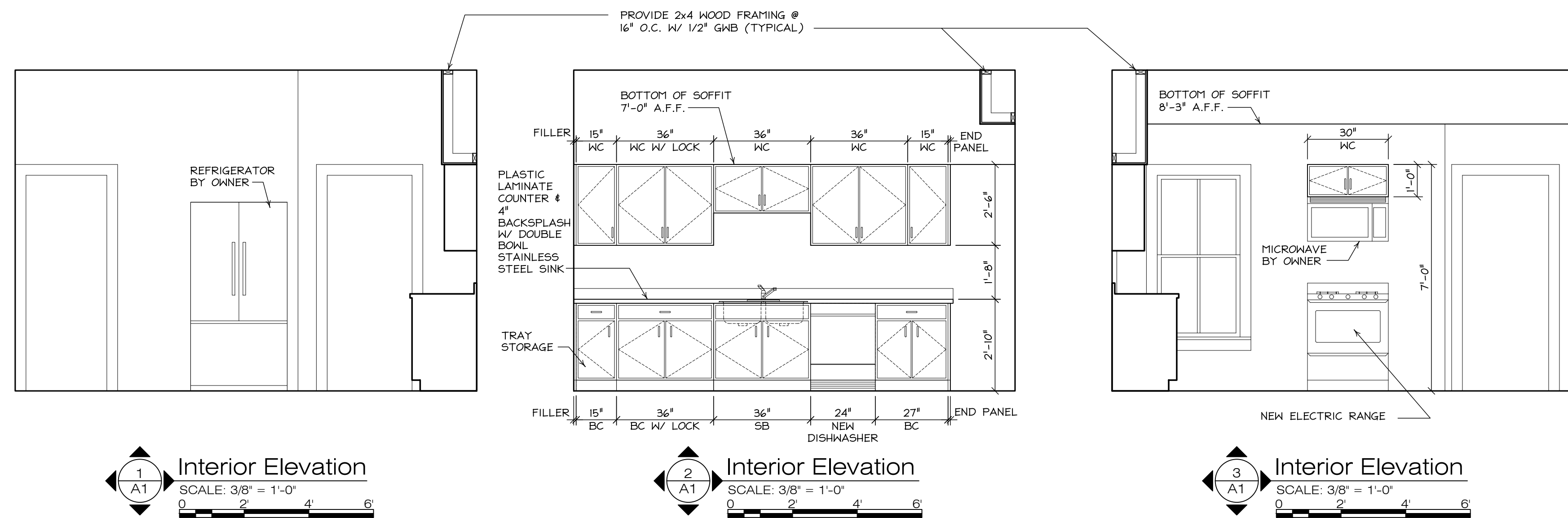

1 Interior Elevation
SCALE: 3/8" = 1'-0"
0 2 4 6

2 Interior Elevation
SCALE: 3/8" = 1'-0"
0 2 4 6

3 Interior Elevation
SCALE: 3/8" = 1'-0"
0 2 4 6

NOTES:

1. REMOVE EXISTING SUSPENDED CEILING. INSTALL NEW G.W.B. CEILING AS CLOSE TO ORIGINAL PLASTER CEILING AS POSSIBLE. REROUTE EXISTING PIPING IN NEW SOFFIT.
2. PATCH AND PAINT EXISTING WALLS, DOORS, AND TRIM.
3. REMOVE EXISTING CARPET TILES AND INSTALL NEW LUXURY VINYL FLOORING.
4. CABINETS TO BE KRAFTMAID CABINETS OR EQUAL.

SPECIFICATIONS:

DIVISION 09 FINISHES

GYPSONUM WALL BOARD

GYPSONUM WALL BOARD TO BE 48" x MAXIMUM LENGTH AVAILABLE TO MINIMIZE JOINTS; THICKNESS AND TYPE PER PLANS 'U.S. GYPSUM,' 'GEORGIA PACIFIC,' OR EQUAL LISTED AS ACCEPTABLE BY TESTING LABS. PROVIDE FIRE-RATED GYPSONUM BOARD WITHIN FIRE ASSEMBLIES; PROVIDE WATER RESISTANT PRODUCT AT ALL WET AREAS. GYPSONUM BOARD SCREEN ATTACHED TO FRAMING. PROVIDE CORNER BEADS, EDGE TRIM, AND CONTROL JOINTS.

JOINT TREATMENT

TAPE AND SPACKLE ALL JOINTS, 3 COATS. SAND AND SPACKLE WORK SMOOTH BETWEEN COATS AND AFTER THIRD COAT. FEATHER JOINTS WITH SUCCESSIVE COATS TO PRODUCE A SMOOTH SURFACE.

PAINTING

PAINTING SCHEDULE BELOW REFERS TO PAINTING PRODUCTS AS MANUFACTURED BY 'SHERWIN WILLIAMS CO.' OTHER ACCEPTABLE MANUFACTURERS ARE 'BENJAMIN MOORE CO.', 'CON LUX,' AND 'PPG.' APPLICATION SHALL BE BY BRUSH OR ROLLER. SPRAY APPLICATION ONLY UPON ACCEPTANCE BY THE ARCHITECT.

INTERIOR GYPSONUM WALLBOARD - EGGSHELL-FINISH LATEX
1ST COAT SHERWIN WILLIAMS 200 PRIMER
2ND COAT SHERWIN WILLIAMS 200 EGGSHELL
3RD COAT SHERWIN WILLIAMS 200 EGGSHELL

RESILIENT TILE FLOORING

VCT: ARMSTRONG NATURAL CREATIONS DIAMOND 10 LUXURY VINYL FLOORING 0.125 THICKNESS. COLOR TO BE SELECTED BY OWNER.

DIVISION 10 SPECIALTIES

CASEWORK

1. CASEWORK TO BE SIMILAR OR EQUAL TO KRAFTMAID SQUARE RAISED PANEL DESIGN, SOLID OAK WOOD, PLYWOOD CONSTRUCTION UPGRADE AND MID TONE FINISH.
2. PULLS TO BE BACK MOUNTED DECORATIVE STYLE.
3. HINGES TO BE CONCEALED EUROPEAN-STYLE SELF-CLOSING HINGES.
4. DRAWER GLIDES TO BE EPOXY-COATED-METAL, SELF-CLOSING DRAWER GLIDES WITH NYLON-TIRES, BALL-BEARING ROLLERS.

Fixture Schedule

MARK	FIXTURE	MFG.	MODEL	C.W.	H.W.	WASTE	VENT	REMARKS
(A)	COUNTER SINK	GLACIER BAY	VDR322A0	1/2"	1/2"	1 1/2"	1 1/2"	FAUCET DELTA #2195LF-SS W/ SIDE SPRAYER & BASKET DRAIN

PLUMBING NOTES:

1. ALL PLUMBING FIXTURES SHALL BE FURNISHED AS SPECIFIED OR APPROVED EQUAL.
2. ALL PLUMBING FIXTURES TO BE VENTED AS PER CODE.
3. ALL WATER LINES SHALL HAVE SHUT-OFF VALVES, OR ANGLE STOPS AT FIXTURE LOCATIONS.
4. PIPE HANGERS TO BE SPACED PER INDUSTRY STANDARDS OR GOVERNING CODES.
5. ALL WATER LINES ABOVE GROUND TO HAVE ONE (1) INCH THICK FIBERGLASS INSULATION WITH VAPOR BARRIER.
6. SANITARY LINES TO HAVE MIN. 1/8 INCH/ FOOT SLOPE.
7. WATER LINES IN CEILING TO BE ADJUSTED TO CLEAR DUCTWORK OR OTHER OBSTACLES.
8. PLUMBING CONTRACTOR SHALL FURNISH AND INSTALL ALL PIPE, FITTINGS, VALVES, FIXTURES OR ANY OTHER MATERIAL AND LABOR NECESSARY TO COMPLETE SYSTEM.
9. PLUMBING CONTRACTOR SHALL BE RESPONSIBLE FOR ALL NECESSARY PERMITS AND FEES.
10. PLUMBING CONTRACTOR SHALL VISIT PROJECT SITE AND FAMILIARIZE HIMSELF WITH ALL CONDITIONS INHERENT WITH THIS PROJECT. THE CONTRACTOR SHALL ASSUME RESPONSIBILITY FOR PROBLEMS NOT INCORPORATED ON DRAWINGS. THE OWNER WILL NOT ALLOW EXTRA FEES FOR ANY CONDITION OVERLOOKED, OR OBSTACLES IN WAY OF COMPLETION OF THIS PROJECT THAT ARE NOT PRESENTED TO THE ENGINEER PRIOR TO SUBMITTING BID.
11. ALL WORK SHOWN ON DRAWING PERTAINING TO SANITARY SYSTEM, AND INTERIOR DOMESTIC WATER SERVICE BY PLUMBING CONTRACTOR.

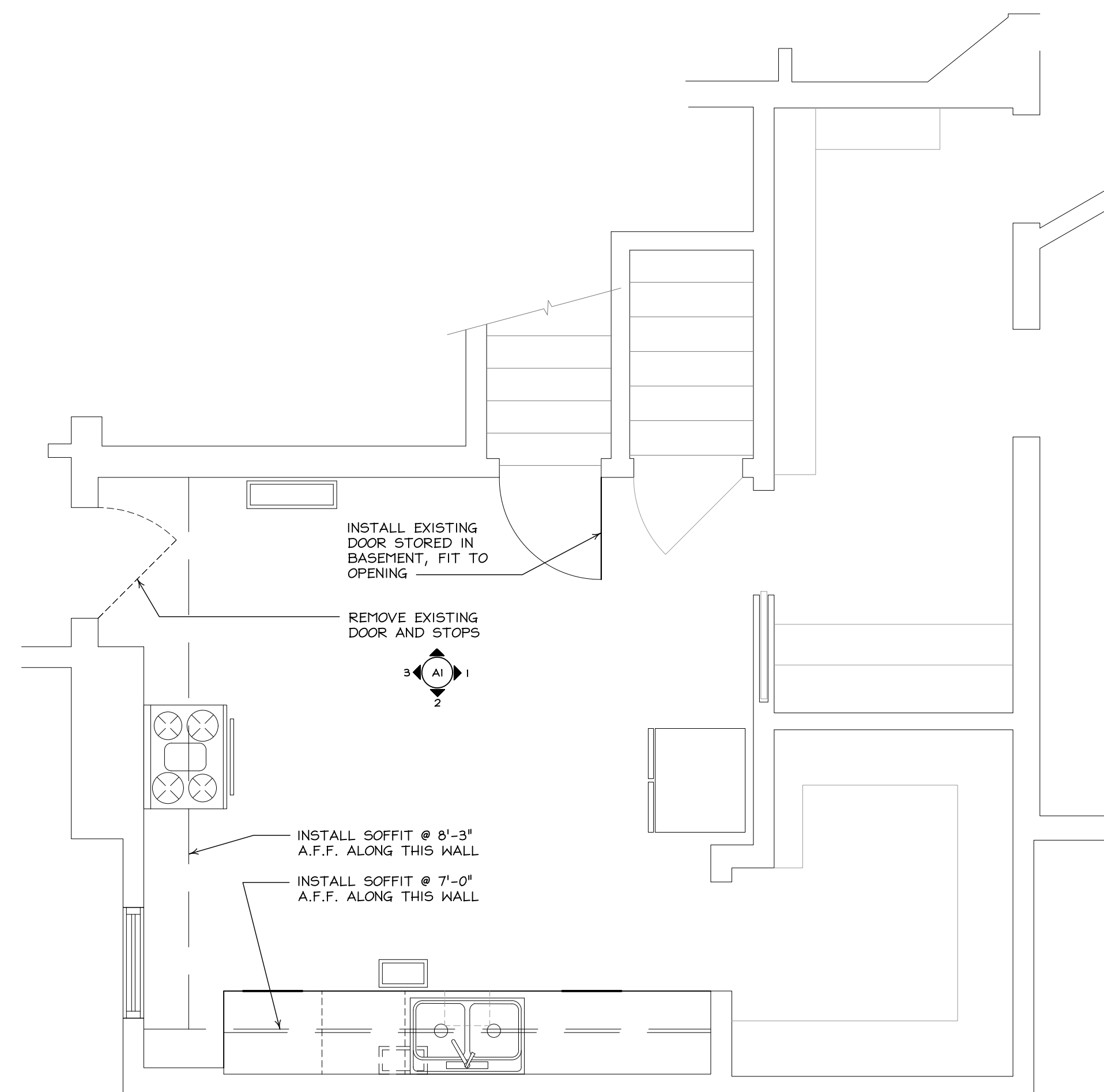

Kitchen Plan
SCALE: 3/8" = 1'-0"
0 2 4 6

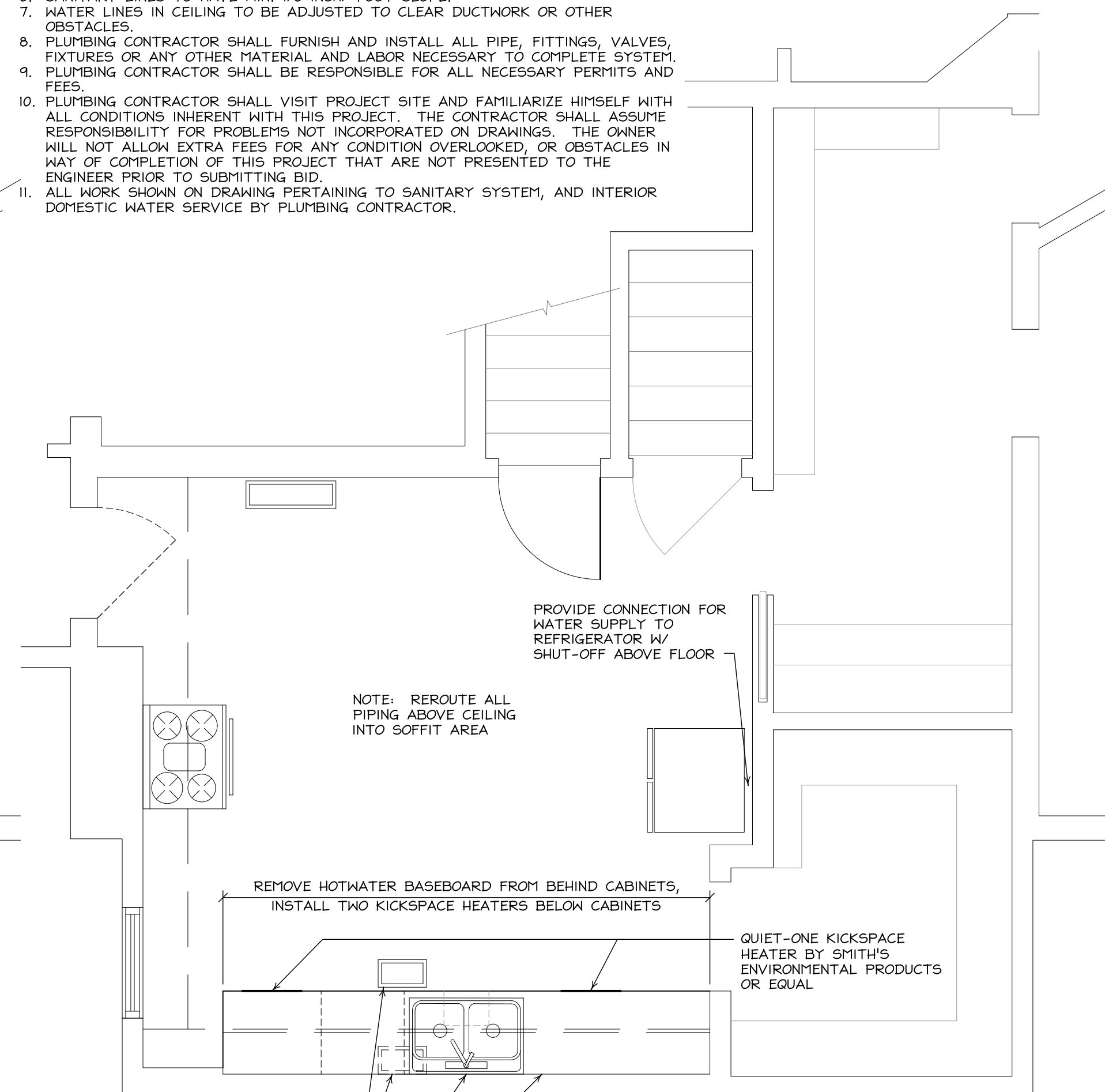

Kitchen Plan - HVAC/Plumbing
SCALE: 3/8" = 1'-0"
0 2 4 6

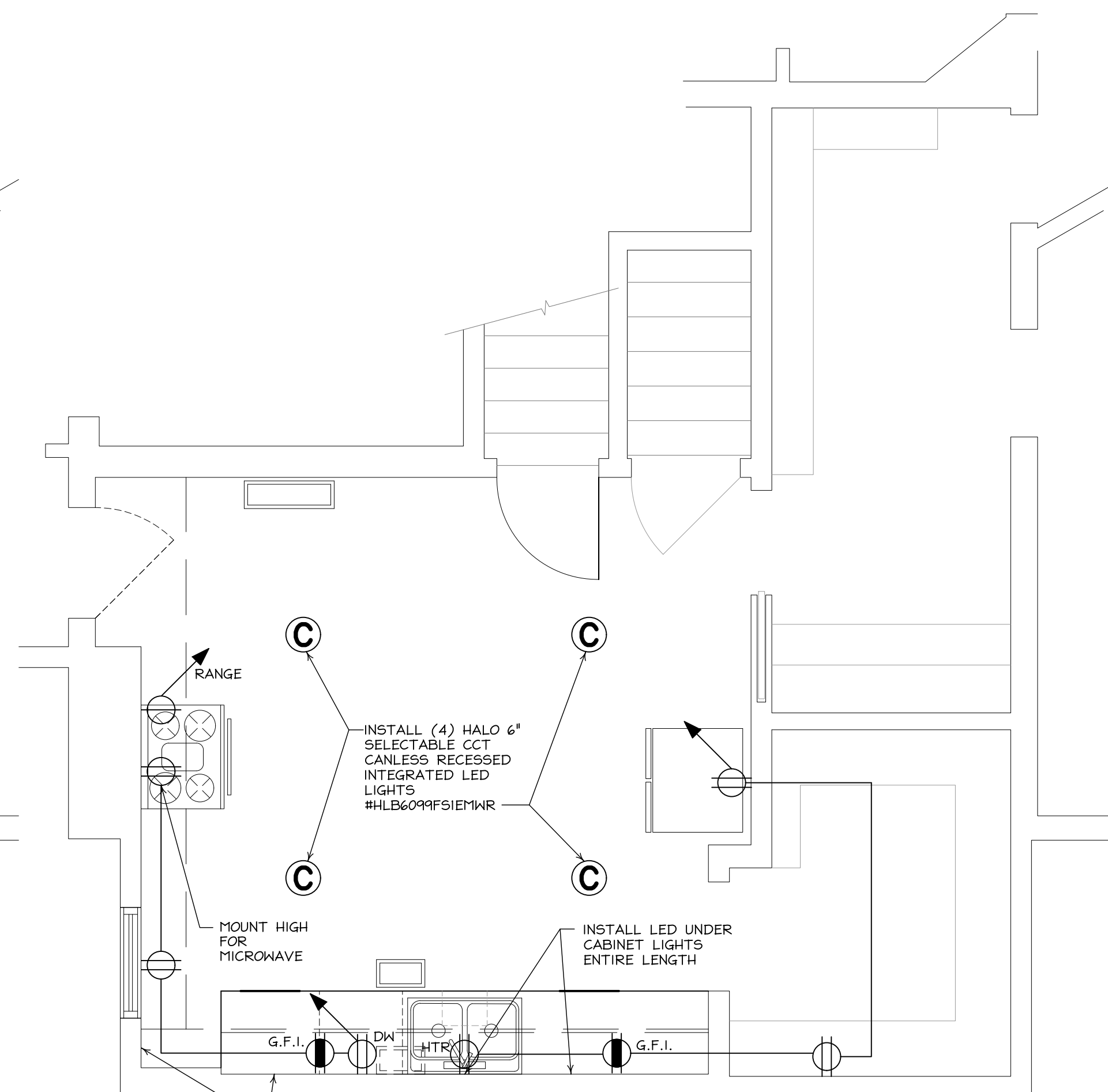

Kitchen Plan - Electrical
SCALE: 3/8" = 1'-0"
0 2 4 6

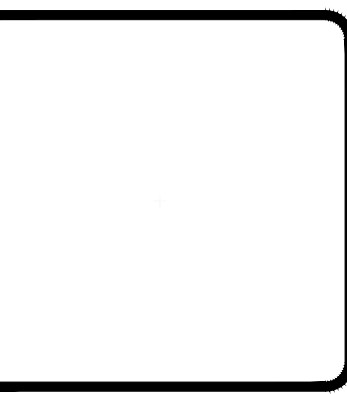
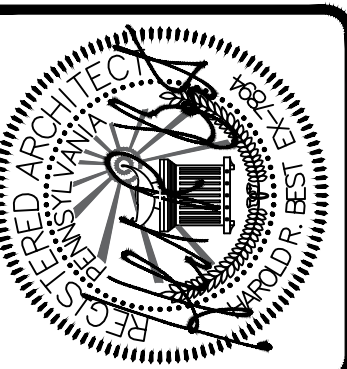

STRUXURES
ARCHITECTURE / CONSTRUCTION
9545 State Route 257
Seneca, PA 16346
Phone: (814) 676-1432
Phone / Fax: (814) 676-1532

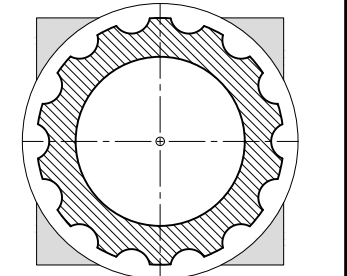

Revisions

Kitchen Rehabilitation
Scheide House
221 North Washington Street, Titusville, PA 16354
Drawing Name
Kitchen Plan and Elevations

Scale: As Noted
Job Number: 013-20
Date: 07.10.2019
Drawn: DMG
Check: HRB
Drawing Number:

A1